

PT2600

6 Channel PRT Input Module

The PT2600 PRT input module offers six channels of PRT inputs suitable for use with 2, 3 or 4 wire probes of type Pt100. PRT (platinum resistance thermometers) are also known as RTD (resistance temperature devices) and offer high accuracy and repeatability over a wide temperature range. Field wiring from the probe can be connected directly to the inputs without the need for any additional terminals. The inputs have built-in protection to 30Vdc and can survive accidental short circuits. Conversion is carried out according to IEC751 ($\alpha=0.00385$) or JIS C1604 ($\alpha=0.003916$) and results can be returned in degrees Celsius or degrees Fahrenheit.

The PT2600 has dual RS485 busses allowing two PCs to simultaneously connect to the network of modules. When used with appropriate software such as enVigil-FMS, dual-redundant systems can be implemented to maximise data availability.

Specification

- 6 PRT inputs for Pt100 probes
 - 2 wire, 3 wire and 4 wire probes supported
 - Protected to 30Vdc and against short circuits
- DIN rail mounted enclosure
 - Width 23mm
 - Height 85mm
 - Depth 105mm
 - Weight 85g
- Power supply
 - 24VDC $\pm 10\%$
 - 100mA (typ.), 200mA (max.)
- Interfaces
 - RS485 host, 19k2 baud, 1.2km
 - RS485 aux, 19k2 baud, 1.2km
 - Maximum number of devices 32
- Environmental
 - Operating temperature 0 to 50°C
 - Storage temperature -20 to 60°C
- Measurement
 - 3 or 4 wire, internal jumper selectable
 - 2 wire using external links
 - Range -200°C to +850°C
 - Accuracy $\pm 0.15^\circ\text{C}$ (4 wire, -185°C to +400°C)
 - Accuracy $\pm 0.25^\circ\text{C}$ (4 wire, -200°C to +850°C)
 - Current matching (3 wire) $\pm 0.5\%$
 - Temperature coefficient $0.005^\circ\text{C}/^\circ\text{C}$
 - Series mode rejection 65dB @ 50/60Hz

Ordering Information

- PT2600 6 Channel PRT Input Module

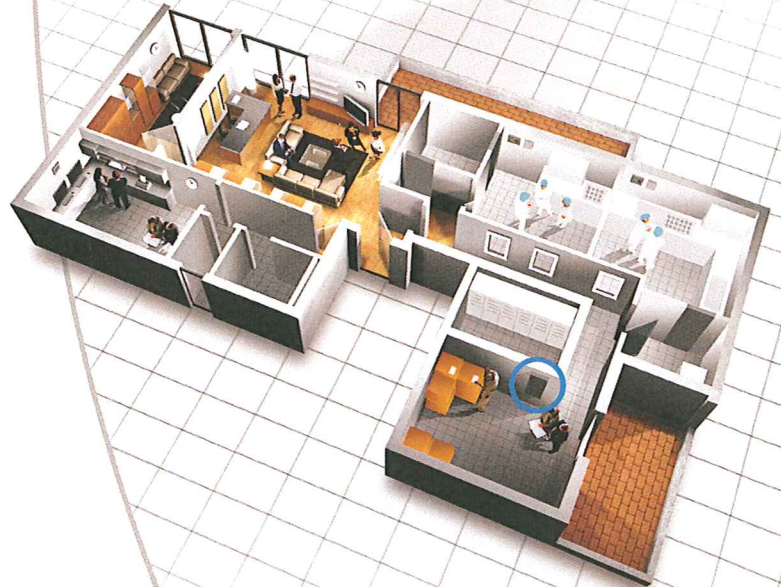
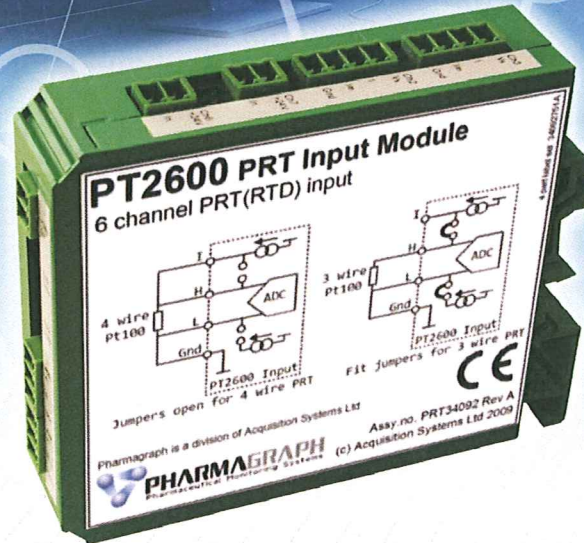

Pharmagraph is a division of Acquisition Systems Ltd

Pharmagraph, 3 Lakeside Business park, Swan Lane, Sandhurst, Berkshire, UK, GU47 9DN

Tel: +44 (0) 1252 861700 Fax: +44 (0) 1252 861155

www.pharmagraph.co.uk e-mail: sales@pharmagraph.co.uk

Document 34092174 Rev A © Acquisition Systems Ltd 2009



PHARMAGRAPH
Pharmaceutical Monitoring Systems