



AI2800

8 Channel 4-20mA Analog Input Module

The AI2800 Analog Input module offers eight channels of 4-20mA analog inputs. Ideal for use with differential pressure, temperature and humidity sensors, the analog inputs can be used with loop powered sensors or with sensors that require a 24Vdc supply. Field wiring from either type of sensor can be connected directly to the input connectors without the need for any additional DIN rail terminals. The 24V energisation supply available at each of the 4-20mA inputs has built-in current limiting allowing them to survive accidental short circuits without needing to replace any fuses.

The AI2800 has dual RS485 busses allowing two PCs to simultaneously connect to the network of modules. When used with appropriate software such as enVigil-FMS, fault tolerant systems can be implemented to maximise data availability. Alternatively the second bus can be used as a host RS485 bus extender allowing more flexible network topologies to be deployed.

Specification

- 8 Analog inputs for 4-20mA sensors
 - Loop powered
 - 24Vdc powered, current limited
- DIN rail mounted enclosure
 - Width 23mm
 - Height 85mm
 - Depth 105mm
 - Weight 85g
- Power supply
 - 24VDC $\pm 10\%$
 - 200mA (max.)
- Interfaces
 - RS485 host, 19k2 baud, 1.2km
 - RS485 aux, 19k2 baud, 1.2km
- Environmental
 - Operating temperature 0 to 50°C
 - Storage temperature -20 to 60°C
- Measurement
 - DC setting accuracy $\pm 0.05\%$
 - Temperature coefficient 25ppm/°C
 - Series mode rejection 65dB

Ordering Information

- AI2800 Analog Input Module, 8 analog inputs

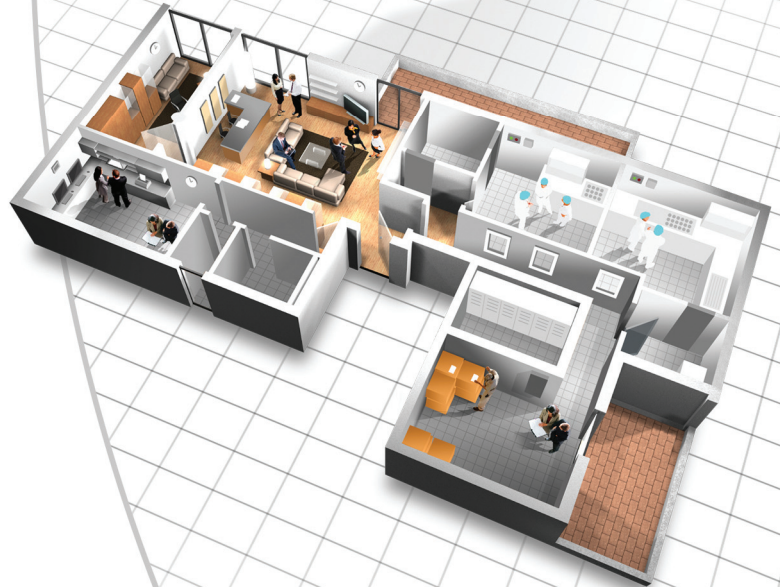

Pharmagraph is a division of Acquisition Systems Ltd

Pharmagraph, 39 Ivanhoe Road, Hogwood Industrial Estate, Finchampstead, Berkshire, RG40 4QQ UK

Tel: +44 (0) 1252 861700 Fax: +44 (0) 1252 861155

www.pharmagraph.co.uk e-mail: sales@pharmagraph.co.uk



PHARMAGRAPH
Pharmaceutical Monitoring Systems